

# ECL-AM10Q

10.1" DIGITAL WATERPROOF FULL TOUCH MONITOR  
FOR HEAVY DUTY INDUSTRY

Design and Specifications are subject to change without notice.

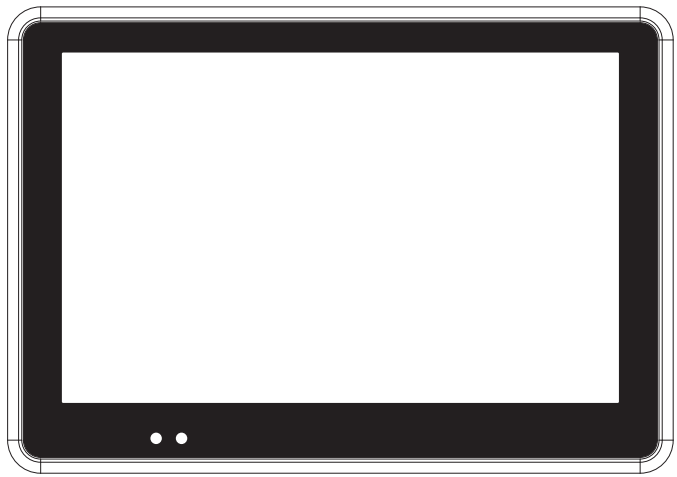

Monitor screen can be difficult to see when exposed to direct sunlight. If your surroundings are too bright to see the screen, such as outdoors in direct sunlight, avoid direct sunlight or use a sun visor.

Perfect Quality, On-Time Delivery & Speedy A/S

RELEASE DATE NOV 18, 2024

PRINTED IN KOREA

## PACKAGE CONTENTS

Please check that you have the correct contents before using this product.  
If any items are missing, please contact your dealer.

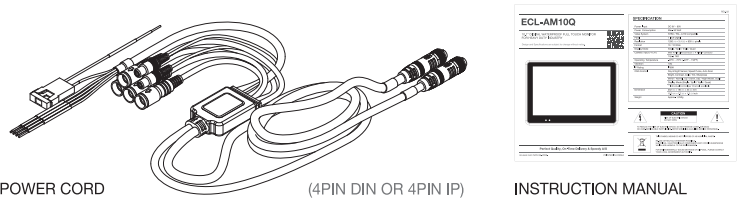
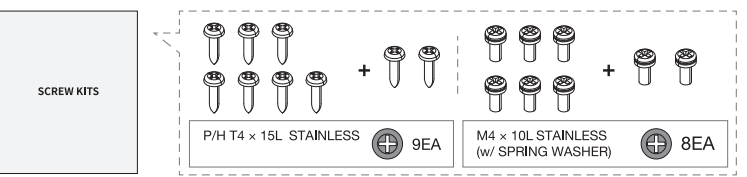

You are cautioned that any changes or modifications which is not expressed or approved in this manual could void your warranty and cause the equipment to malfunction.

## SPECIFICATION

Power Input	DC 9V ~ 80V
Power Consumption	Max. 30 Watt
Video System	NTSC / PAL, A-HD compatible
Panel	10.1 Inch Digital
Brightness	500cd/m²
Resolution	1280 (H) × 3 (RGB) × 800 (V) pixels
Format	16 : 10 Wide
Display Mode	Single / Split / Triple / Quad
Camera input ( 4 CH )	Mini 4 PIN DIN Connector or 4 PIN IP Connector
	1Vp-p 75Ω
Operating Temperature	-40°C ~ 70°C ( -40°F ~ 158°F)
Vibration	10G
IP Rating	IP69K
OSG Control	Day & Night Sensor, Speed Pulse, Auto Scan
	Bright, Contrast, Color, Tint, Sharpness
	Mirror / Normal, Up / Down, Day / Night Mode
	Display Mode (Single / Split / Triple / Quad)
	* Individual Control per Channel available
Dimension	262 (W) × 183 (H) × 33 (D) mm
	10.3 (W) × 7.2 (H) × 1.3 (D) inch
Weight	Approx. 1,250g (Monitor Only)

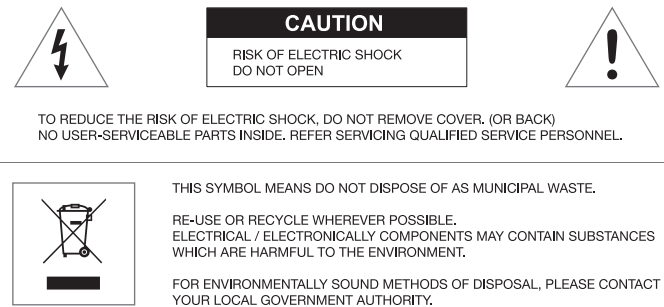

## SYSTEM CONNECTION

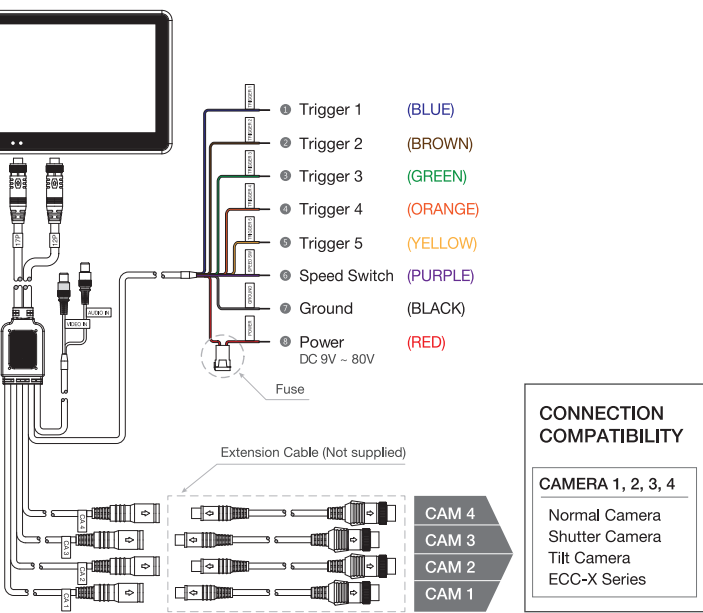

## BRACKET INSTALLATION

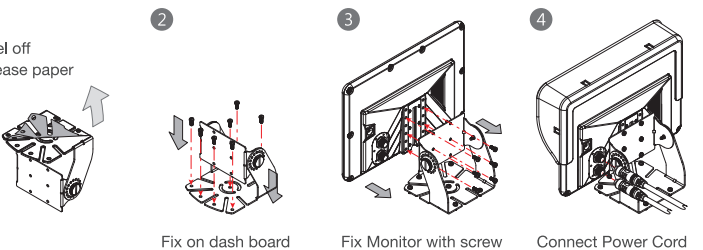

## CAUTION BEFORE USAGE



## OPERATIONS

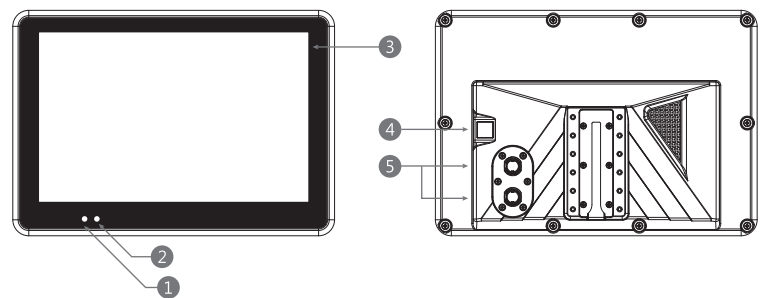

1 POWER LED	Power connected, Screen on	LED GREEN
	Power connected, Screen off	LED RED
	Power disconnect	LED OFF
2 DAY / NIGHT SENSOR	Auto brightness sensor. Automatically adjust screen brightness based on the current lighting conditions.	
	Tap to screen on. Tap  to screen off on bottom right of <b>CHANNEL LIST</b> menu screen.	
3 SCREEN	Tap	Touch screen with your finger.
	Tap and Hold	Touch screen and hold more than 2 second.
	Tap and Drag	Touch and hold screen while you drag.
4 Restart button	Press button to restart monitor. Use when monitor is crashed and stop operating.	
5 Plug	Connect two Power Connectors (12 Pin and 17 Pin Cable) to Plug. You must connect both cable connector to operate Monitor.	

## CHANNEL LIST

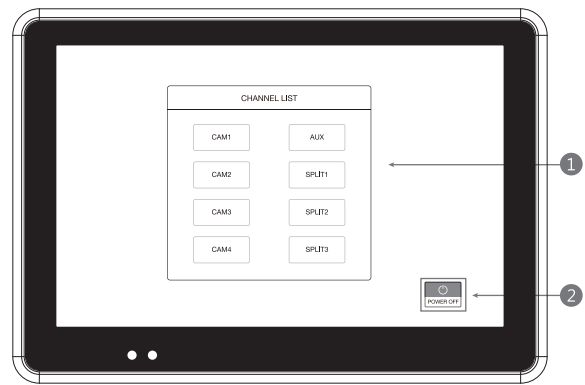

Tap to pop up CHANNEL LIST.  
CHANNEL LIST disappears within 7 seconds if there is no more touch input.

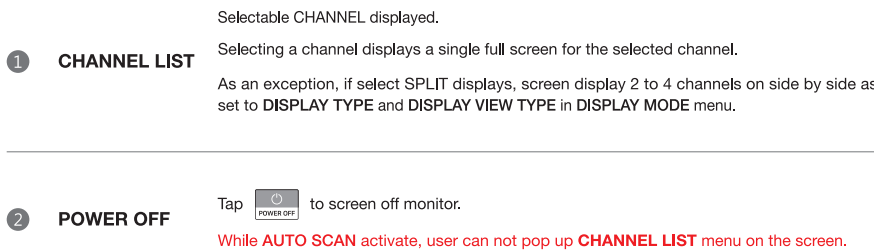

While AUTO SCAN activate, user can not pop up CHANNEL LIST menu on the screen.

OPERATIONS - MENU

MENU

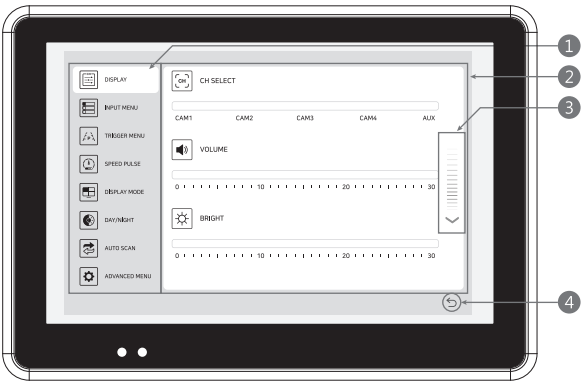

Tap and hold to pop up MENU.  
MENU disappears within 7 seconds if there is no more touch input.

- 1 Main Menu**
  - Selectable Main Menu displayed.
  - Each main menu has its own sub menu. Tap Main Menu to enter Sub Menu
- 2 Sub Menu**
  - Sub Menu is selected by tap Main menu, and it will be displayed on the right side of Main Menu.
- 3 Page Indicator**
  - If all Sub Menu can not be displayed on the screen, Page Indicator is activated.
  - Tap to move on to the next page.
- 4 ESC**
  - Tap to escape MENU

1 DISPLAY

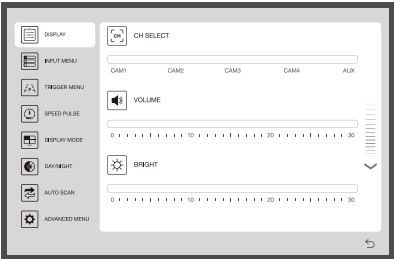

- CH SELECT**
  - Select the channel you want to set. Each channel can have different settings.
- VOLUME**
  - Adjust the Volume of Monitor.
- BRIGHT**
  - Adjust Color's Lightness on the screen.
- CONTRAST**
  - Adjust contrast of different colors.
- COLOR**
  - Adjust the Color shown on the screen.
- TINT**
  - Adjust the amount of white added to the original color.
- SHARPNESS**
  - Adjust the clarity displayed on the screen.

2 INPUT MENU

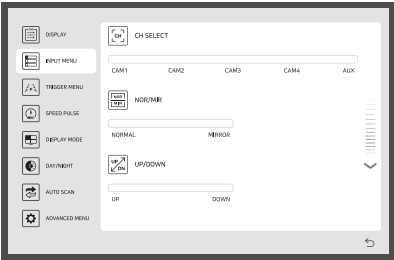

- CH SELECT**
    - Select the channel you want to set. Each channel can have different settings.
  - NOR/MIR**
    - Adjust Normal or Mirror view. Mirror View is vertical reflect of Normal View.
  - UP/DOWN**
    - Adjust Up or Down view. Down View is horizontal reflect of Up View.
  - SORT**
    - Different types of camera (Normal / Shutter / Tilt) can be connected to each channel. Some Type of Camera has additional setting options.
- | Option | Camera Type | Action   |
|--------|-------------|--|
| LED    | X SERIES    | Turn the White LED ON and OFF of the X SERIES Camera |
| TILT   | MANUAL TILT | Adjust View Angle of the Tilt Camera by tap          |

3 TRIGGER MENU

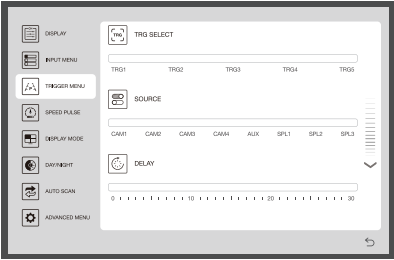

- TRG SELECT**
    - Select the trigger you want to set. Each trigger can have different settings.
  - SOURCE**
    - Set each trigger by selecting 4 cameras and AUX, 3 split displays.
  - DELAY**
    - Delay time of each trigger is adjustable 0 to 30 seconds.
      - NOTE : If one camera is activated by an intermittent or wave signal (e.g directional lights) the delay should be set enough longer than wave length to prevent flickering picture.
  - MARKER**
    - If MARKER is set to ON, Parking Marker is visible on screen when trigger is enabled. Adjust the position and width of Parking Marker by Tap and Drag.
- |                   | Position of Marker       | Width of Marker             |
|-------------------|--------------------------|-----------------------------|
| <b>MARKER SET</b> | <br>DRAG UP<br>DRAG DOWN | <br>DRAG RIGHT<br>DRAG LEFT |

OPERATIONS - MENU

4 SPEED PULSE



- FUNCTION ON/OFF**
  - PURPLE wire needs to be connected with the vehicle's tacho signal and SPEED PURSE needs to selected ON.  
\* Wire Color can be changed, check the named sticker on wire first.
- FREQUENCY**
  - Selectable activated Frequency is 10 to 1,000Hz.  
\* Different type of tacho signal has different Frequency value for the same speed.
- UNDER FREQUENCY CH**
  - When set speed is reached, UNDER FREQUENCY CHANNEL is turned off. Slows down, selected camera will be ON automatically again at same frequency.
- OVER FREQUENCY DISPLAY**
  - Set OVER FREQUENCY DISPLAY to ON.  
\* OVER FREQUENCY DISPLAY cannot be activated when SPEED PULSE is off.
- OVER FREQUENCY CH**
  - When set speed is reached, OVER FREQUENCY CHANNEL is turned on. Slows down, screen returns to UNDER FREQUENCY CHANNEL.

5 DISPLAY MODE

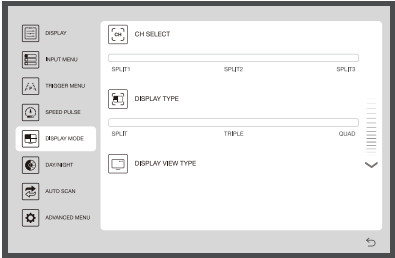

- CH SELECT**
    - Select the channel you want to set. Each channel can have different settings.
  - DISPLAY TYPE**
    - Select the number of Cameras displayed.
  - AUDIO**
    - Audio function is only available on selected channel.
  - DISPLAY VIEW TYPE**
    - Tap **DISPLAY VIEW TYPE** to activated. and Choose DISPLAY VIEW TYPE.
- | SPLIT DISPLAY TYPE | TRIPLE DISPLAY TYPE | QUAD DISPLAY TYPE |
|--------------------|---------------------|-------------------|
|                    |                     |                   |
- SOURCE**
    - Set each SPLIT DISPLAY by selecting 4 cameras and AUX. Same camera input can be set at same time in each source.
    - If AUX is set, CAM4 cannot be used. The same applies to the opposite case.

6 DAY / NIGHT

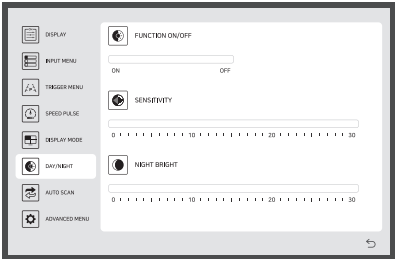

- FUNCTION ON/OFF**
  - DAY / NIGHT Sensor detects the current lighting conditions. If dark, DARK Mode activate.
- SENSITIVITY**
  - Closer to 30, DARK Mode is activated when darker.
- NIGHT BRIGHT**
  - Adjust the screen brightness while DARK Mode is activated.

7 AUTO SCAN



- FUNCTION ON/OFF**
  - The Function to play or skip each channel or SOURCE display on the screen in preset order. Tap to PAUSE AUTO SCAN and tap again to AUTO SCAN.  
NOTE : While AUTO SCAN function activate, user can not pop up CHANNEL LIST menu on the screen.
- CAM1**
  - CAM 1~4 Delay
- AUX**
  - AUX Delay
- SPLIT**
  - SPLIT Delay

8 ADVANCED MENU

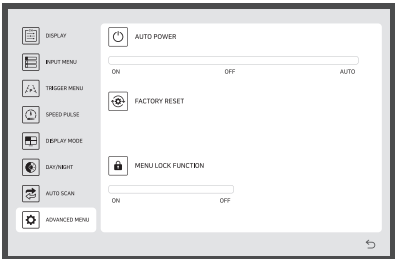

- AUTO POWER**
  - AUTO POWER ON**
    - Monitor starts with screen on.
  - AUTO POWER OFF**
    - Monitor starts with screen off.
  - AUTO POWER AUTO**
    - The state of the screen (on or off) is remembered before turning off the ignition. The state of the remembered screen is maintained when the power is turned on again.
- FACTORY RESET**
  - Reset for Factory Setting.
- MENU LOCK FUNCTION**
  - Passwords can be used to prevent users from accessing the menu.